

## ROUND LED LIGHT ENGINES

### LER SERIES

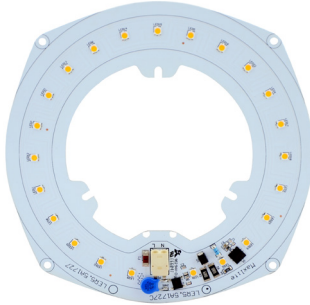

**LER5.5**  
5.5" Dia., 17W, 1430-1500lm

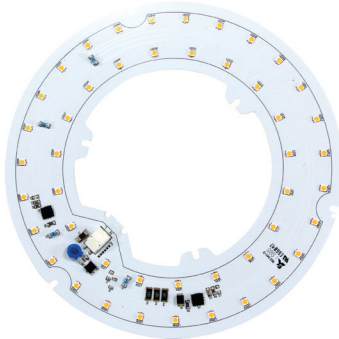

**LER7.0**  
7" Dia., 23W, 2145-2200lm



### FEATURES:

- Easy integration into new fixture construction (requires heatsink)
- Integral driver-on-board, connects directly to 120VAC
- High CRI available
- Suitable for center lockup and keyhole fixture pans
- Dimmable to 5% (with ELV/LED dimmers)
- UL Recognized for use in luminaires

### CONSTRUCTION:

- Lumileds 3030 2D chips
- Metal core board
- Push in wire connector accepts up to 18ga conductors for easy field supply wire connections

### EQUIVALENCIES FOR 5.5"

- 2x60W Incandescent
- 2x13W CFL
- 22W T9 Circline

### EQUIVALENCIES FOR 7.0"

- 2x75w Incandescent
- 2x18w CFL
- 32w T9 Circline

### APPLICATIONS:

- Ceiling Light
- Flush Mount fixtures
- Pendant Fixtures

**WARNING:** RISK OF FIRE AND ELECTRICAL SHOCK. THIS PRODUCT IS TO BE INSTALLED AND SERVICED BY QUALIFIED PERSONNEL ONLY.

**CAUTION:** WHEN USING ELECTRICAL EQUIPMENT, BASIC SAFETY PRECAUTIONS SHOULD ALWAYS BE FOLLOWED. TO AVOID POSSIBLE ELECTRICAL SHOCK, BE SURE THAT POWER SUPPLY IS TURNED OFF BEFORE INSTALLING OR SERVICING THIS ENGINE. THIS ENGINE IS DESIGNED FOR USE IN THE MANUFACTURING OF NEW FIXTURES ONLY, IS NOT DESIGNED TO BE A RETROFIT SOLUTION, AND MUST BE INSTALLED IN AN APPLICATION WHERE MARKED TC POINT DOES NOT EXCEED MAXIMUM RATINGS. USE OF A METAL HEAT SINK IS RECOMMENDED. 120VAC COMPONENTS MUST NOT BE TOUCHED WHEN ENERGIZED.

MODEL SELECTION (Full list of order codes on pg. 2)

Typical order example: LER5.5A1727C

LER			
FAMILY	DIAMETER AND WATTAGE	CCT	CRI
LER= Round Light Engine	<b>5.5A17=</b> 5.5 Inch Diameter, 17W <b>7.0A23=</b> 7 Inch Diameter, 23W	<b>27=</b> 2700K <b>30=</b> 3000K	<b>(OMIT)=</b> 80  <b>C=</b> 90

ACCESSORIES			
ORDER CODE	MODEL NUMBER	DESCRIPTION	ACCESSORY IMAGE
74936	LER5.5IB	Optional Glass Isolation Barrier for 5.5" Engine	
74861	LER7.0IB	Optional Isolation Barrier for 7" Engine	

### COMPATIBLE DIMMERS:

MAKE	DIMMER MODEL
Lutron	DV-600P
Lutron	DVELV-300
Lutron	SELV-300
Leviton	IPL-06

### NOTE:

1. Isolation barrier over the engines required for Safety listing. MaxLite accessories can be used, or other user-supplied cover, or fixture diffuser. If fixtured diffuser used, note that Safety listing will require tools for access to the engine compartment.

**SPECIFICATIONS:**

		LER5.5 A1727	LER5.5 A1727C	LER5.5 A1730	LER5.5 A1730C	LER7.0 A2327	LER7.0 A2327C	LER7.0 A2330	LER7.0 A2330C
ITEM	SPECIFICATION	DETAILS							
GENERAL PERFORMANCE	Lumens Delivered (lm)	1500	1430	1500	1430	2200	2145	2200	2145
	Efficacy (lm/W)	87	82	87	82	95	90	95	90
	CRI	80	90	80	90	80	90	80	90
	Power Consumption (W)	17		17		23		23	
	Color Temperature	2700K		3000K		2700K		3000K	
	Color Consistency	Proprietary binning for uniform color							
	L70 Lifetime (hours)	50,000 Hrs							
ELECTRICAL	Power Factor	0.980							
	Input Voltage	120V							
PHYSICAL	Operating Temperature	0°-104°F							
CERTIFICATION	Certification	UL, FCC, LM-79, LM-80							
	Material Usage	RoHS compliant; no mercury							
	Environment	Damp Location							
	Warranty	5 years							

**ORDERING:**

ORDER CODE	ITEM #	DIAMETER	WATTAGE	CCT	CRI
74902	LER5.5A1727	5.5 Inches	17W	2700K	80
74903	LER5.5A1727C	5.5 Inches	17W	2700K	90
76727	LER5.5A1730	5.5 Inches	17W	3000K	80
76728	LER5.5A1730C	5.5 Inches	17W	3000K	90
74816	LER7.0A2327	7 Inches	23W	2700K	80
74832	LER7.0A2327C	7 Inches	23W	2700K	90
76729	LER7.0A2330	7 Inches	23W	3000K	80
76730	LER7.0A2330C	7 Inches	23W	3000K	90

**LIGHT ENGINE LINE DRAWINGS:**

LER5.5  
5.5" Dia., 17W, 1430-1500lm

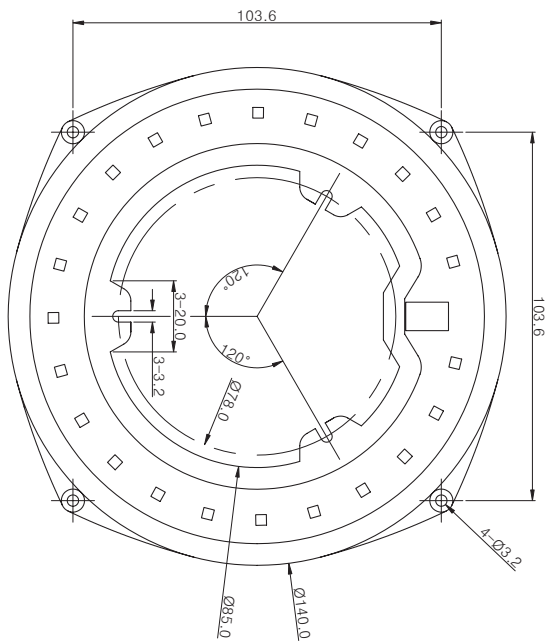

LER7.0  
7" Dia., 23W, 2145-2200lm

